

Bishop's Waltham- *Matters*

October 20
Issue 52

Welcome

For all those who thought that life would be easier during this pandemic for your Councillors without the number of public meetings they have to attend, I can now confirm that they were not correct. The last 6 months have resulted in our meetings being held from home via internet links, and they are not as easy as imagined. There have been very few that have not experienced a technical problem with some Councillors "dipping out" of meetings at times.

Despite these issues, we have carried out our duties as best we can in the circumstances, although many of our planned projects have been delayed because of the Government restrictions resulting from their everchanging working rules and advice.

The final stages of the car park extension at The Jubilee Hall has yet to be completed although it is able to be used at present. Other projects that were planned to be implemented over future years, such as the construction of a footpath / cycleway linking the new development site in the Albany Farm area to the old railway track (via the other development sites and Priory Park), are already under discussion with Winchester and Hampshire Council officials earlier than anticipated.

The various Parish Council Committees are now discussing our financial budgets for the next three years, a task that is more difficult than normal because of the effects from the loss of income this year normally received from the hire of Council facilities.

Finally, I would like to thank all the volunteers who assisted Parish Council staff and Councillors to deliver medicine and food to our vulnerable residents during the "lockdown" periods. A typical example of the Bishop's Waltham community spirit coming to the fore.

Thank you all for your support in these difficult and uncertain times.

Councillor Terry Wilson - Chairman

-Quick Updates-

From October 2020 Jubilee Hall Car Park will be Pay and Display. Terms and Conditions can be found on our website.

Unfortunately, the installation of the proposed playgrounds at Ponside will be delayed until 2021.

Plans are underway to make upgrades to existing playgrounds, to include resurfacing, painting and new gates.

This newsletter is brought to you by Bishop's Waltham Parish Council

Get updates as they happen.

Join us on Social Media.



Bishops Waltham Parish Council



@BWCouncil



Double Yellow Line Reinstatement

Winchester City Council have confirmed that the works order to re-instate the double yellow lines pictured on the plan, have been agreed. The planned works will start soon and they hope for them to be completed by the end of October 2020.

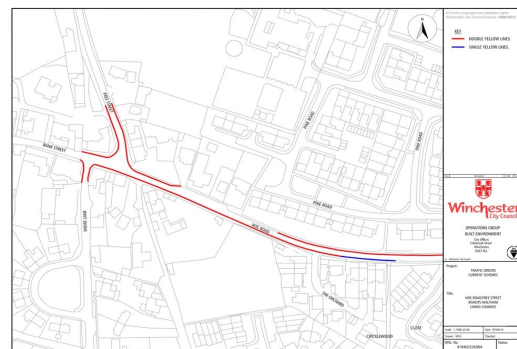

Work on the proposed parking restrictions to relieve traffic congestion on Free Street and Shore Lane are on-going, and will be publicly consulted on in due course

Remembrance Day Events

Wednesday 4th November (3pm) - Dedication of the Garden of Remembrance - War Memorial, St Peter's Church
 Sunday 8th November (10.30-11.30am) - Church Parade & Service - High Street/War Memorial/ St Peter's Church
 Wednesday 11th November (11am) - Two Minute Silence and Air Raid Siren - High Street



All planned Remembrance Day events will be held in accordance with Government COVID-19 Guidance and are subject to change.

Poppy Appeal

This year will be different to other years. The Royal British Legion are calling on the public to take part and wear their poppies with pride to make sure the Appeal is as successful as always. A Poppy Appeal stand will be operating in the High Street for the two weekends before remembrance day.

Clean-up BW Event

A very big thank you to all those who gave up their Saturday morning to volunteer at our annual town litter pick event on Saturday 19th September.



We really do appreciate your time and hard work.

Face Mask Disposal

Please dispose of used Face Masks properly, preferably in a lined bin.



Used masks should not be left discarded where other people may come into contact with them. Leaving masks lying around both contributes to litter and the risk of infection for other people.

On Tuesday 11th of August, the Mayor of Winchester visited Bishop's Waltham to meet and thank all those who ensured the community were supported during the isolation period.



On Saturday 15th August at 11am, to commemorate VJ Day (Victory over Japan), we laid a wreath at the war memorial on behalf of the people of Bishop's Waltham.



Community Support Line

In early March the Parish Council, led by Cllr Shields, began the process of setting up a support line for residents self-isolating (shielding) using the Council's Emergency Plan.

Community Organisations were approached and quickly responded to the request for volunteers. The support line went 'live' on 23rd March 2020 and was manned by the office staff and some councillors.

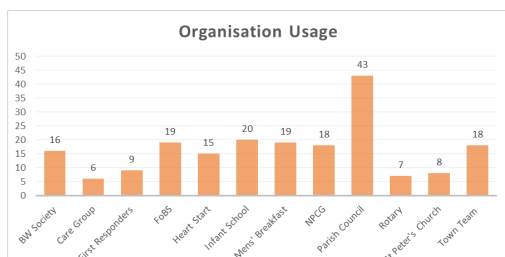

The call handlers endeavoured to spread the usage of volunteers to ensure no one organisation was overloaded. The Parish Council ran its own Friday collection for prescriptions which explains the high number.

The support line ran for 19 weeks until the lifting of the Government guidelines on shielding.

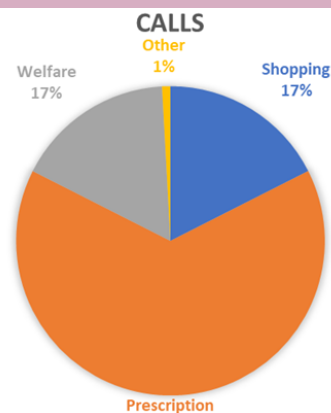
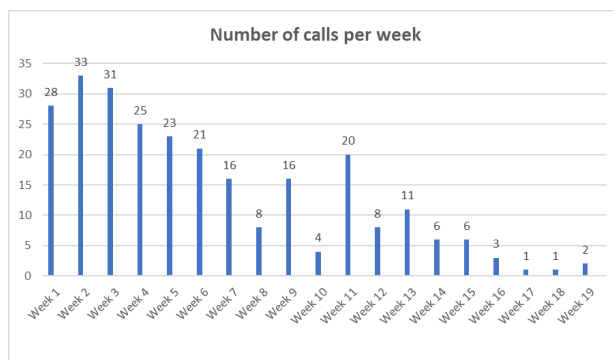

Details of all calls were logged and weekly summary provided to show the type of calls and the organisation usage.

The Support line has now been closed, however, should the need arise again the information is at hand to restart the service.

Which Council is Responsible?

Hampshire County Council is responsible for:-

Highway management Waste disposal Children's services (including supporting schools, families and young people) Social care Libraries Discovery Centres Country parks Public Health
ww.hants.gov.uk - 0300 5551375



Hampshire
County Council

Winchester City Council is responsible for:-

Housing Benefits Business Waste, recycling and street cleaning Planning Climate emergency Arts Building control Community safety and neighbourhood services Council tax Licensing Parking Pest control
www.winchester.gov.uk - 01962 840222



Winchester
City Council

Bishop's Waltham Parish Council is responsible for:-

Allotments Burial Grounds, Cemeteries, Churchyards and Crematoria Bus Shelters Bye-laws Public Clocks Community Centres, Halls, Public Buildings Drainage – of ditches and ponds Provision of litter-bins and support for any anti-litter campaigns Planning – parish councils may be notified of any planning applications for the area Public conveniences Recreation · Public Seats Signs – danger signs, place names and bus stops signs Traffic Calming War Memorials
ww.bishopswaltham-pc.gov.uk - 01489 892323



Meet the Councillor

Cllr Barry Nicholson

Born in Winchester in 1952 I grew up on the family farm at West Hoe and was educated in Swanmore and Eastleigh. Apart from short spells living in Upham and Swanmore, and 12 years in Scotland, I have lived in Bishop's Waltham nearly 50 years. I retired from a 40 year career in aviation to go back to farming.

Chairman of the Halls & Grounds Committee



Parish Councillor Representation

As you can see from the diagram below the home locations of our Parish Councillors are evenly spread throughout Bishop's Waltham, giving a fair representation throughout the community. Contact details for all Councillors can be found on our website www.bishopswaltham-pc.gov.uk



Spotlight on: What's On @ The Jubilee Hall

We were pleased to recently open up the Jubilee Hall to some of our hirers.
We have worked hard to ensure the hall is COVID safe and our hirers are adhering to all Government guidelines.
Please contact the organiser directly to make enquiries.

Rachel Ison Yoga

Tuesdays - 9.15am to 10.15am

@rachelisonyoga

07557 382034

Tuesday Badminton

Tuesdays - 8pm to 9.30pm

01489 896738

Football Tots

Wednesdays - 13.45pm to 14.30pm

<https://active100.co.uk/100-football/>

07917 726120

Clubbercise

Thursdays - 6.45pm to 7.45pm

josioclubbercise@aol.com

07841836443

Country Market

Fridays - 10am to 12pm

enquiries@bwcountrymarket.co.uk



Contact Us

For all enquiries relating to Parish Council matters or facilities, please use the following details:-

Address: Parish Council Office
The Jubilee Hall
Little Shore Lane
Bishop's Waltham
SO32 1ED

Telephone: 01489 892323

Email: parishclerk@bishopsvaltham-pc.gov.uk
Web: www.bishopsvaltham-pc.gov.uk

The Parish Council Office is not currently open to the public, please do contact us by phone or email.

Council and Committee Meeting Dates

(All meetings are currently held online until further notice. Details for public access can be found on the meeting agendas uploaded to our website or on the town noticeboards)

October 2020

6th Finance, Policy and Resources Committee
13th Parish Council
20th Halls and Grounds Committee
26th Community Development Committee
27th Planning and Highways Committee

November 2020

3rd Finance, Policy and Resources Committee
10th Parish Council
17th Halls and Grounds Committee
23rd Community Development Committee
24th Planning and Highways Committee

December 2020

1st Finance, Policy and Resources Committee
8th Parish Council
15th Halls and Grounds Committee