



Bishop's Waltham Parish Council
A Meeting of the Parish Council's Planning and Highways Committee will be held in
the Ruby Room in the Jubilee Hall, Bishop's Waltham
on Tuesday 25th February 2025 at 7.00pm.

The meeting will be open to the public unless the Committee directs otherwise.

Agenda

All papers/reports are available from the Council office (except where classified as confidential).

1. To receive and accept apologies for non-attendance
2. To receive and accept declarations of disclosable pecuniary interests relating to items on this agenda
3. To receive and accept any personal, pecuniary & non-pecuniary interests relating to items on this agenda
4. Public Session – *for information only*
5. Parish Council's Tree Warden's Report - to consider any motion put to the meeting as a result
6. Parish Rights of Way Warden's Report - to consider any motion put to the meeting as a result
7. To approve the minutes of the Planning and Highways Committee – 28th January 2025
8. Actions Arising from the meeting of the Planning and Highways Committee – 28th January 2025
- for information only
9. Financial position year to date – *to note current position*
10. Planning Applications: to ratify responses from Chairman, Vice Chairman and Clerk
11. Planning Applications for consideration:

25/00139/PNHOU

Closing Date: 18.2.25

Single Storey flat roof extension with parapet. Overall dimension approximately 4.5m length (extension) width 4.5m

23 Gunners Park, Bishop's Waltham, SO32 1PD

24/02633/OUT

Closing Date: 24.2.25

Outline Application for new 3 bedroom self-build detached dwelling within the garden of 15 Princes Close

15 Princes Close, Bishop's Waltham So32 1RL

24/02766/HOU

Closing Date: 27.2.25

Single Storey hobby room/store in rear garden

Bywell, Garfield Road, Bishop's Waltham SO32 1AT

25/00256/HOU

Closing Date: 6.3.25

Proposed two storey side extension to main house; conversion of existing barn into home office and leisure space

Moorlands, Hoe Road, Bishop's Waltham SO32 1DU

12. Planning Applications: Decisions by WCC Delegated Officers/Committee, SDNP Planning Authority and Appeal Decisions - *for information.*
13. Footpath Creation Proposal - Consultation – *for consideration*

14. New Premises Licence Application – Consultation – *for consideration*
15. Waste Bins – Request for Additional Sites in Bishop's Waltham – *for consideration*
16. South Downs National Park – Local Plan Review Response – *for consideration*
17. Winchester City Council Projects
 - i) Public Toilets – Update – *for consideration*
 - ii) Car Park Bin Store – Update from WCC and Proposal from BWPC Councillor – *for consideration*
18. Correspondence – *for consideration*
 - i) Hampshire Water Transfer and Water Recycling Project - Consultation
 - ii) Botley Bypass Roundabout - Update
 - iii) M27 Junction 10 Improvement Scheme - Update
 - iv) St George's Square BT Red Telephone Kiosk Removal - Consultation
19. Accessibility Project – Update – *for consideration*
20. Chairman's report – *for information only*
21. Requests for future agenda items – *for information only*
22. Date of next meeting – Tuesday 25th March 2025
23. Motion for confidential business:
The following motion will be moved on the completion of the above business: That in view of the confidential nature of the business about to be transacted, it is advisable in the public interest that the public and press be temporarily excluded, and they are instructed to withdraw in accordance with the provisions of the Public Bodies (Admissions to Meetings) Act 1960.
24. WCC and SDNPA Enforcement Lists – *for consideration*
25. WCC – Revised Local Enforcement Plan Consultation – *for consideration*

EMcKenzie

Clerk to the Committee 18.2.25

Right of Way Report for February 25

Power tools training: Two of our path wardens, Alan Powell and Mark Bowditch, have applied for the power tool training at Sparsholt College on 9th May. A bridleway, **BW 15**, at Dean, has already been identified to be the first path in need of clearance. In recent years this has become impassable during summer.

Mud has been an over-riding feature of our Rights of Way this last month which has resulted in rather limited checking and cutting back of any vegetation this month.

Yet another volunteer has come forward this month, Ian Tyldesley. Recently retired and fit, he will be a great asset to our volunteer team.

Ruth Shields

February 2025

Bishop's Waltham Footpaths



Hampshire
County Council

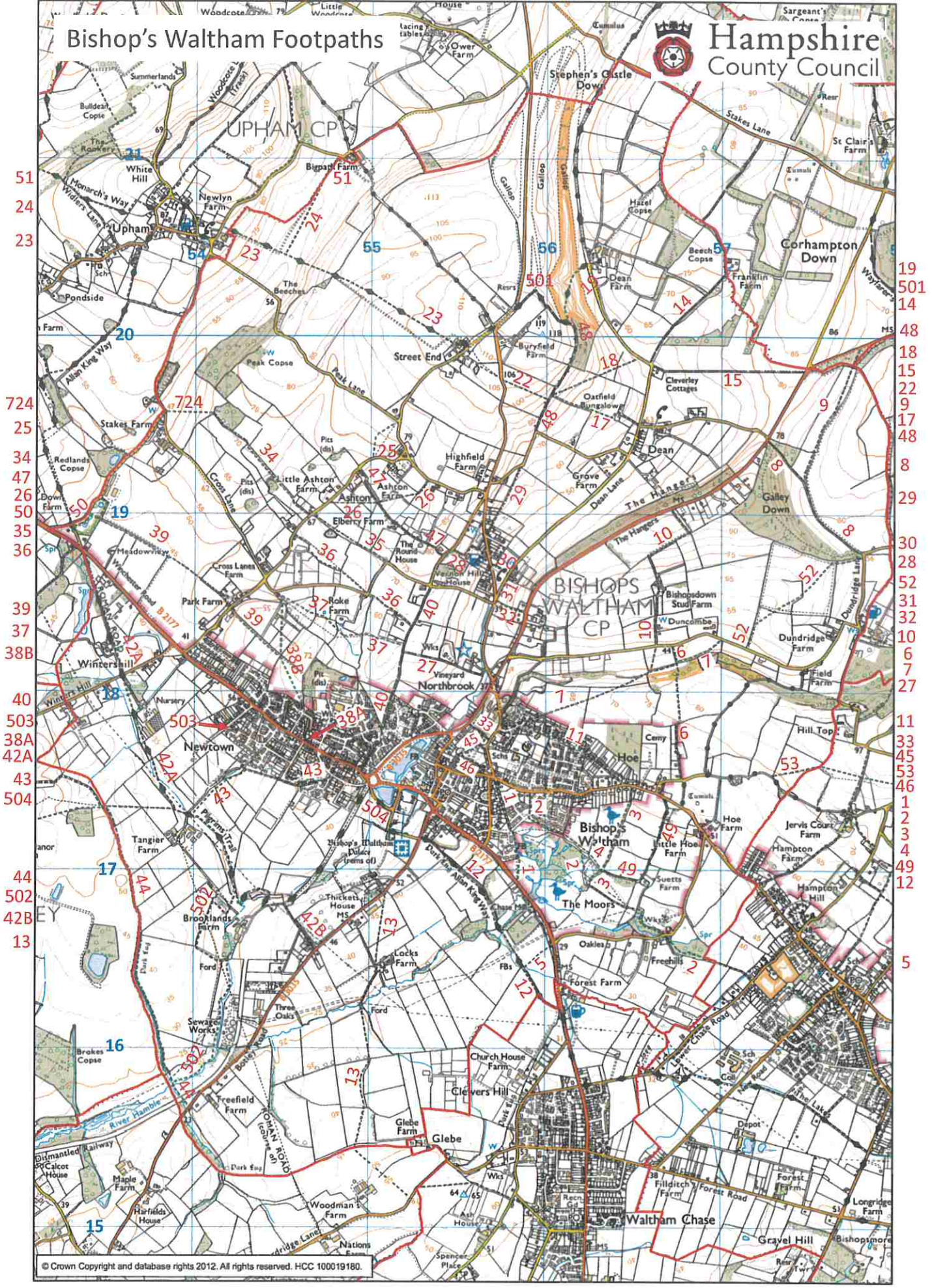



BISHOP'S WALTHAM PARISH COUNCIL

**Minutes of the meeting of the Parish Council Planning and Highways Committee
held at the Jubilee Hall, Bishop's Waltham on Tuesday 28th January 2025 at 7.00pm**

Present:	Cllr Conduct Cllr Homer Cllr Jelf Cllr Jones Cllr Marsh Cllr Sherwood Cllr Wood	Vice Chairman of the Committee Chairman of the Committee Substitute member (Co-opted)
Also in attendance:	Mrs McKenzie Mrs Shields	Committee Clerk/Executive Officer Parish Rights of Way Warden
Members of Public:	2	

PH157/24 To receive and accept apologies for non-attendance

Due to the resignation of a Committee member, as per agenda item following, a substitute member was coopted onto the Committee for the evening. The proposal for this agenda item was changed to reflect this need.

Resolved: To coopt Cllr Marsh onto the Committee for the evening's meeting

Proposed: Cllr Conduct

Seconded: Cllr Sherwood

All in favour

PH158/24 To receive any declarations of disclosable pecuniary Interests on items on the agenda.

None.

PH159/24 To receive any declarations of personal, pecuniary and non-pecuniary interests on items on the agenda.

None.

PH160/24 Resignation from Committee

Resolved: To accept and note the resignation of Cllr Nicholson from the Committee as tabled

Proposed: Cllr Jelf

Seconded: Cllr Sherwood

All in favour

PH161/24 Public Session

The two members of the public wished to speak at the time of the appropriate agenda item regarding Beeches Hill Traffic Survey and the Twenty's Plenty Initiative.

A chase to Hampshire Highways regarding the approved new road markings at The Crown roundabout was requested.

A road sign at St George's Square was noted for replacement.

An additional bin at the North Pond duck feeding area was requested but this was felt to be unlikely to be granted as other bins were nearby and waste may encourage further vermin at the site.



PH162/24 Parish Council's Tree Warden Report - to consider any motion put to the meeting as a result.

Mrs Grover had tendered her apologies and her notes on 25/00006/TPO were considered.

PH163/24 Parish Rights of Way Warden's Report - to consider any motion put to the meeting as a result.

Report noted.

Thanks were given to the ROW Warden and Cllr Conduct for their assistance in the completion of the kissing gate installation on Footpath 43.

The self-closing gates on Footpath 12 were due to be installed in Summer 2025 when the weather improves. In the meantime, additional way markers would be positioned.

A number of trees were noted as falling on footpath routes due to recent storms – these were identified for clearance by HCC.

A further footpath warden had been recruited and training on power tools for two wardens planned.

The Rights of Way Warden left the meeting at this point.

PH164/24 Minutes of Meeting of the Planning and Highways Committee – 26th November 2024

Resolved: to approve the minutes of the meeting of the Planning and Highways Committee of the 26th November 2024

Proposed: Cllr Conduct

Seconded: Cllr Wood

All in favour who were at the meeting on 26th November 2024.

PH165/24 Actions Arising from the Minutes of the meeting of the 26th November 2024

The Executive Officer noted that many action points were agenda items this month.

PH166/24 Financial Position Year to Date

Resolved: To note the financial position year to date

Proposed: Cllr Sherwood

Seconded: Cllr Wood

All in favour.

PH167/24 Planning Applications: to ratify the responses from the Chairman, Vice Chairman and Clerk.

Two applications were highlighted.

SDNP/24/05135/FUL – neutral, no objection.

24/02655/TPC – neutral – tree warden comment to replace elsewhere in garden if possible.

Resolved: To ratify the planning application responses from the Chairman, Vice Chairman and Clerk

Proposed: Cllr Wood

Seconded: Cllr Marsh

All in favour



PH168/24 Planning Applications
25/00006/TPO

Closing Date: 28.1.25

T1 English Oak of the MWA Arboricultural Report

Works: Remove to as close to ground level as possible

Reason: Clay shrinkage subsidence damage at the property

36 Siskin Close, Bishop's Waltham SO32 1EQ

Tree Warden to comment. Refer to WCC Arboricultural Officer. If application approved then replacement tree recommended.

25/00047/TPO

Closing Date: 3.2.25

T1 Ash – Fell to ground level

Reason – Ash dieback symptoms observed within canopy

Colwyn, Winchester Road, Bishop's Waltham SO32 1BD

Tree Warden to comment. Refer to WCC Arboricultural Officer.

SDNP/25/00066/LIS

Closing date 6.2.25

To infill the well to the rear of the house which has no fabric visible above ground level

Street End House, Street End, Bishop's Waltham SO32 1FS

Neutral. No objection.

25/00083/TPC

Closing Date 25.2.25

T1 Red Oak – Reduce in height by up to 5 metres and reduce over extended branches to improve shape and exposure to large winds

T2 Beech – Reduce west side by up to 1.5 metres to maintain distance from building.

T3 Poplar – Remove branches back to main stem on west side to maintain distance from building

Roman Row, Bank Street, Bishop's Waltham

Neutral. No objection.

24/02627/FUL

Closing Date: 28.1.25

Retrospective change of use of agricultural land to residential curtilage associated with adjacent dwelling

Springfields, Winchester Road, Waltham Chase, SO32 2LL

Application noted as withdrawn.

Proposed: Cllr Conduct

Seconded: Cllr Wood

All in favour.

PH169/24 Planning Applications. Decisions by WCC Delegated Officers/Committee, SDNP Planning Authority and Appeal Decisions.

Noted.

PH170/24 Footpath Warden Training

The courses were considered and the location of the training centre and duration of course highlighted. It was suggested a back up volunteer be selected in case one could not attend and a replacement ready.

Resolved: To recommend to the Finance, Policy and Resources Committee the course regarding power tool training at Sparsholt College for two footpath wardens at a cost of £409.00 per person.

Proposed: Cllr Conduct

Seconded: Cllr Wood

All in favour

ACTION: Executive Officer



PH171/24 Traffic Survey at Beeches Hill - Report

The report by Hampshire County Council was presented and data therein considered. The two members of the public present raised concerns regarding traffic speed and pedestrian safety when using the road. The Committee acknowledged concerns and highlighted actions taken to support residents in referring such to the responsible body, Hampshire County Council. The report gave a summary of satisfaction which the Committee duly noted.

Resolved: To note the traffic survey at Beeches Hill undertaken in December 2024

Proposed: Cllr Jones

Seconded: Cllr Wood

All in favour

PH172/24 Twenty's Plenty Consultation – Report from Cllr Jones

The paper was presented by the Committee Chairman highlighting the findings of the public consultation held in November 2024.

Resolved: To note the outcome of the Twenty's Plenty Consultation and not pursue the initiative further at this time.

Proposed: Cllr Jones

Seconded: Cllr Conduct

All in favour

The two members of the public left the meeting at this time.

PH173/24 Accessibility Project Update

The update was noted.

PH174/24 Improvements at the B2177/The Avenue Junction

The update on the project was positively received. The bus shelter at the location was considered for replacement.

Resolved: To not replace the bus shelter outside The Spar on the B2177

Proposed: Cllr Jelf

Seconded: Cllr Sherwood

All in favour

PH175/24 Correspondence

Two pieces of correspondence were tabled highlighting road safety concerns on the B2177. It was suggested that representatives of Hampshire Highways attend the Annual Meeting of the Parish to listen to community concerns and offer professional advice.

A meeting with Hampshire Highways representatives was recommended to consider junctions onto the B2177 and also speed limit areas such as the Corhampton Road and Beeches Hill.

ACTION: Refer idea of Hampshire Highways reps at AMP to CEC

ACTION: Executive Officer

ACTION: Call meeting with Hampshire Highways reps

ACTION: Executive Officer

PH176/24 Junctions onto the B2177 – Monitoring Plan

This agenda item was considered in relation to the previous one.

Resolved: To not set up a monitoring plan at this time but consider after the meeting with Hampshire Highways representatives

Proposed: Cllr Jones

Seconded: Cllr Wood

All in favour



PH177/24 SID posts Installation and Renewal of S72 Licence

The update from Hampshire County Council was noted.

Resolved: To note the progress in SID post installation and approve the cost for the renewal of the S72 Licence

Proposed: Cllr Conduct

Seconded: Cllr Jones

All in favour.

PH178/24 Design Statement – Review

This agenda item was merged with the next one to consider both planning projects.

Resolved: To appoint a working group of Cllr Conduct, Cllr Homer and Cllr Wood to review the South Down National Park local plan and draft a response and plan the review process for the Design Statement.

Proposed: Cllr Conduct

Seconded: Cllr Marsh

All in favour.

ACTION: Cllr Conduct, Cllr Homer and Cllr Wood

PH179/24 South Downs National Park – Local Plan Review

This agenda item was merged with the previous one.

PH180/24 Chairman's Report

It was noted that, during the gap in meetings during December and January, the Chairman had undertaken many operational decisions this month alongside the Committee Clerk and Vice Chairman.

PH181/24 Requests for future agenda items

Bus Shelter opposite Sainsbury's Garage – Condition Report and Suggestions for Action

Update from the South Downs National Park working group regarding the Local Plan review

PH182/24 Date of next meeting - Tuesday 25th February 2025

Noted.

PH183/24 Motion for confidential business: The Chairman then moved: That in view of the confidential nature of the business about to be transacted, it is advisable in the public interest that the public and press be temporarily excluded, and they are instructed to withdraw in accordance with the provisions of the Public Bodies (Admissions to Meetings) Act 1960.

PH184/24 WCC and SDNPA Enforcement Lists

Noted.

A follow up on three listed cases was requested.

ACTION: Executive Officer

There being no further business the meeting closed at 8.43pm.

Bishop's Waltham Parish Council

Actions Arising from the Planning & Highways Committee meeting 28.1.25

Minute Number	Subject	Action	Date for completion	Action by	Notes
PH080/23(iii), PH098/23, PH242/23, PH21/24	Dog bins	Sites at Botley Rd and Winchester Rd to be considered	Sep-23	EO	Agenda item Sept 23 to consider sites - Deer Walk, Shore Lane, Botley Rd. Agenda item June 24.
PH118/23	School Crossing Patrol	To write to HCC about H&S concerns	Nov-23	EO	Matters in public domain
PH148/23	Bus Shelter Posters	To investigate posters for poster holders	Jan-24	EO	
PH167/23, PH178/24, PH179/24	Ensure Design Statement included in Local Plan updates	To monitor changes and ensure DS included	Oct-24	EO/KJ	Ongoing
PH170/23	Footpath Signage	To liaise with Bargate re footpath signage	May-24	EO/ROW	Discussed June 24.
PH217/23	Contact with HCC	i) Liaise re High St resurfacing and lining ii) Consider suspension of traffic enforcement where lines unclear	Jun-24	EO	
PH87/24	Enforcement Priorities	To meet to set priorities	Complete. Priorities noted to WCC.	EO	3.9.24 5:30pm KJ,BN, JW, MH
PH139/24	Two closing gates	To purchase and install two self closing gates for Footpath 12	Feb-25	ROWW/ EO	Gates purchased. Awaiting installation.
PH170/24	Training Courses	Refer to FP&R for approval	Complete.	EO	Approved by FP&R and PC Feb 2025
PH175/24	AMP Idea	To offer idea of HH rep in attendance	Complete.	EO	Referred to CEC
PH175/24	Meeting with HH rep	To arrange a meeting with a HH rep re B2177	Mar-25	EO	
PH178/24, PH179/24	Planning Working Group (SDNP/ Design Statement)	To meet regularly to monitor topics	Jul-25	TC, MH, JW	
PH184/24	Enforcement Priorities	To follow up on priorities	Mar-25	EO	

Detailed Income & Expenditure by Phased Budget Heading 20/02/2025

Month No: 10

Cost Centre Report

	400	Planning & Highways	Current Month Actual	Current Month Budget	Current Month Variance	Year To Date Actual	Year To Date Budget	Year To Date Variance	Total Annual Budget	Committed Expenditure	Funds Available	% Spent	Transfer to/from EMR
4143	0	Community Payback Scheme	0	0	0	0	0	0	(100)	0	100	0.0%	
4254	0	Costs - Highways Schemes	0	0	0	(326)	0	326	0		(326)	0.0%	
4324	0	Mtce - Bus Shelters	0	0	0	(840)	250	1,090	(500)		(340)	168.0%	
4330	0	Mtce - Town Clock	0	0	0	0	150	150	(150)		150	0.0%	
4333	0	Mtce - Footpaths & Cycleways	0	0	0	(990)	500	1,490	(1,000)		10	99.0%	
4334	(142)	Mtce - Street Furniture	(142)	0	(142)	(637)	300	937	(300)		(337)	212.4%	
4335	0	Mtce - S I D	0	0	0	(395)	0	395	(250)		(145)	158.1%	
499		Capital - Planning & Highways											
1302	0	Grant - Stiles / Kissing Gates	0	0	0	600	500	(100)	500			120.0%	
1331	0	Grant - HCC SID	0	0	0	5,000	0	(5,000)	0			0.0%	
1338	0	Grant - HCC CAPDP Fpath Tools	0	0	0	555	0	(555)	0			0.0%	
4350	(6)	Minor Assets	(6)	0	(6)	(831)	250	1,081	(500)		(331)	166.2%	
4375	0	Speed Indicator Device (ES)	0	0	0	(3,749)	0	3,749	0		(3,749)	0.0%	
4403	0	Street Furniture	0	0	0	(428)	1,000	1,428	(1,000)		572	42.8%	
4404	0	Stiles / Kissing Gates	0	0	0	(484)	500	984	(500)		16	96.7%	
Grand Totals:- Income			0	0	0	6,155	500	(5,655)	500			1231.0%	
Expenditure			148	0	(148)	8,680	2,950	(5,730)	4,300	0	(4,380)	201.9%	
Net Income over Expenditure			(148)	0	148	(2,525)	(2,450)	75	(3,800)				
Movement to/(from) Gen Reserve			(148)	0	148	(2,525)	(2,450)	75	(3,800)				

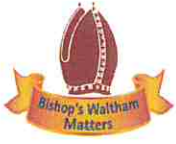

Bishop's Waltham Parish Council

Planning and Highways Committee

25.2.25

Agenda Item 10 - Planning Applications: to ratify responses from Chairman, Vice Chairman and Clerk

None required in February 2025.

Proposal: to ratify responses from Chairman, Vice Chairman and Clerk, if appropriate

Executive Officer 20.2.25



Bishop's Waltham Parish Council

Planning and Highways Committee

25.2.25

Agenda Item 11 - Planning Applications - *for consideration*

25/00139/PNHOU

Closing Date: 18.2.25

Single Storey flat roof extension with parapet. Overall dimension approximately 4.5m length (extension) width 4.5m

23 Gunners Park, Bishop's Waltham, SO32 1PD

24/02633/OUT

Closing Date: 24.2.25

Outline Application for new 3-bedroom self-build detached dwelling within the garden of 15 Princes Close

15 Princes Close, Bishop's Waltham So32 1RL

24/02766/HOU

Closing Date: 27.2.25

Single Storey hobby room/store in rear garden

Bywell, Garfield Road, Bishop's Waltham SO32 1AT

25/00256/HOU

Closing Date: 6.3.25

Proposed two storey side extension to main house; conversion of existing barn into home office and leisure space

Moorlands, Hoe Road, Bishop's Waltham SO32 1DU

Proposal:

To consider the planning applications tabled above and make recommendations as a result.

Executive Officer 20.2.25



Bishop's Waltham Parish Council

Planning and Highways Committee

25.2.25

Agenda item 12: Decisions by Delegated Officer to Winchester City Council, WCC Planning Development Control Committee, South Downs National Park Authority and Appeals inspector up to 28.1.25

None for Bishop's Waltham listed for February 2025 to date.

Executive Officer 20.2.25



Bishop's Waltham Parish Council

Planning and Highways Committee

25.2.25

Agenda Item 13 – Footpath Creation Proposal - Consultation - *for consideration*

See consultation documents following.

Proposal:

To consider the Footpath Creation Proposal as page following and make recommendations/comments as a result.

Executive Officer 20.2.25



Universal Services, The Castle, Winchester
Hampshire SO23 8UL

Telephone 0300 555 1391

www.hants.gov.uk/countryside

Enquiries to

[REDACTED]

My reference **PPO 5256**

Direct Line

Your reference

Date

13 February 2025

E-mail

[REDACTED]

Dear Sir/Madam

Proposed Creation of Footpath rights in Bishops Waltham

Hampshire County Council proposes to create footpath rights in the Parish of Bishops Waltham under section 26 of the Highways Act 1980. A plan showing the proposal is attached.

Hampshire County Council has published a guidance document outlining the criteria that will be considered in assessing applications for diversions, either in the interest of the landowner or of the public. This document can be viewed on the HCC website at the following address and should be read in conjunction with the requirements of the Highways Act 1980.

[https://www.hants.gov.uk/landplanningandenvironment/rightsofway/definitivemap/pa
thorders](https://www.hants.gov.uk/landplanningandenvironment/rightsofway/definitivemap/pa
thorders)

Legal Framework:

Section 26 of the 1980 Act allows authorities to make an order creating footpaths, bridleways and restricted byways where it appears to the authority that there is a need for them:

Compulsory powers for creation of footpaths, bridleways and restricted byways.

1) *Where it appears to a local authority that there is need for a footpath, bridleway or restricted byway over land in their area and they are satisfied that, having regard to—*

Director of Universal Services
Patrick Blogg

(a) the extent to which the path or way would add to the convenience or enjoyment of a substantial section of the public, or to the convenience of persons resident in the area, and
(b) the effect which the creation of the path or way would have on the rights of persons interested in the land...

it is expedient that the path or way should be created, the authority may by order made by them...create a footpath, bridleway or restricted byway over the land.

Guidance published by the Department for Environment, Food & Rural Affairs (DEFRA) in August 2023, provides a steer for local authorities as to the weight they should attach to the impact of public footpaths, bridleways or restricted byways where they run by private houses and gardens, farmyards and commercial and industrial premises. The guidance sets out Government policy on changes to public rights of way in circumstances where a right of way may cause hardship because it goes through the garden of a family home, a working farmyard or other commercial premises.

Proposed Alignment (A-B)

SU 5502 1852 and SU 5495 1813

A 2 metre wide path commencing at a junction with Footpath 36 Point A on the plan (SU 5502 1852) proceeding south-westwards along field edge to connect with Clayland's Local Nature Reserve at Point B (5495 1813).

Approximately 411 metres in length.

Background

A definitive map modification claim has been submitted for this footpath. The landowner has agreed to dedicate the route, and as a result HCC is proposing to process this under Section 26 of the Highways Act. The public use the proposed route as part of the local network connecting Footpath 36, Footpath 37, Bridleway 40 and Clayland's Nature Reserve.

If you have any comments to make and wish them to be considered by the Council, I would be grateful if written submissions could be sent to me at the email address above by the 13 March 2025, if possible. Should you wish to discuss any of the above, please do not hesitate to contact me.

The personal data you provide in any response will be treated in accordance with Data Protection Legislation, and may be published in a decision report, be disclosed to other interested parties, including the landowner (or their representatives). It may also be made public if the matter is referred to the Planning Inspectorate. Your data will be retained for a maximum period of 3 years from the date that the application is resolved. In the event that this changes to a legal event order, it will become part of the permanent records kept on rights of way in Hampshire. The legal basis for our use of this information is the compliance with a legal obligation – Highways Act 1980.

You have some legal rights in respect of the personal information we collect from you. Please see our website Data Protection page for further details:

www.hants.gov.uk/dataprotection You can contact the County Council's Data Protection Officer at data.protection@hants.gov.uk If you have a concern about the way we are collecting or using your personal data, you should raise your concern with us in the first instance or directly to the Information Commissioner's Office at <https://ico.org.uk/concerns/>

Yours faithfully,

A black rectangular redaction box covering the signature of the Data Protection Officer.A black rectangular redaction box covering the name of the Countryside Access Development Officer.

Countryside Access Development Officer

455000

118500

118500



Location Map

B

A

455000



Countryside Access Team
 Universal Services, The Castle
 Winchester, SO23 8UL

**Creation of Footpath
 Rights in Bishops Waltham**

LEGEND 1:1,500

- Footpath
- Bridleway
- - - - - Footpath to be Added

© Crown copyright and database rights 2024 Ordnance Survey 100019180.
 Use of this data is subject to terms and conditions. You are granted a non-exclusive, royalty free, revocable licence solely to view the Licensed Data for non-commercial purposes for the period during which HCC makes it available. You are not permitted to copy, sub-licence, distribute, sell or otherwise make available the Licensed Data to third parties in any form. Third party rights to enforce the terms of this licence shall be reserved to Ordnance Survey.



Bishop's Waltham Parish Council

Planning and Highways Committee

25.2.25

Agenda Item 14 – New Premises Licence Application - Consultation - *for consideration*

See document following.

Proposal:

To consider the New Premises Licence Application as page following and make recommendations/comments as a result.

Executive Officer 20.2.25

From: Licensing <licensing@winchester.gov.uk> **Sent:** 04 February 2025 13:48

To: _Members - All <_Members-All@winchester.gov.uk>

Subject: Application for New Premises Licence - Mi Bello Lugar, Brooklands Farm, Botley Road, Bishops Waltham, Southampton, Hampshire SO32 1DR

Good afternoon

Winchester City Council has received an application from [REDACTED] for a Premises Licence New for Mi Bello Lugar, Brooklands Farm, Botley Road, Bishops Waltham, Southampton, Hampshire SO32 1DR.

The purpose of the application is to provide licensable activities as detailed below:-

Supply of Alcohol Friday to Monday 09:00 to 21:00

(for consumption both
on and off the premises)

Representations from Responsible Authorities or any other person must be received at Winchester City Council offices no later than 4 March 2025.

Only written representations that relate to one or more of the four licensing objectives can be considered. The licensing objectives are:

- The prevention of crime and disorder
- Public safety
- The prevention of public nuisance
- The protection of children from harm

Representations must clearly set out the likely effects the grant of the licence would have on the promotion of at least one of the licensing objectives, and must clearly relate to the premises for which application is being made.

The Act requires the Council to disregard representations that are considered to be frivolous or vexatious or repetitive.

Please note that relevant representations will form part of a public document which will include your name and address and will appear on this website. Anonymous representations will be disregarded.

Please send any Representations or queries regarding this application to licensing@winchester.gov.uk or to the following address:-

Licensing Section
Winchester City Council
City Offices
Colebrook Street
Winchester
SO23 9LJ

The application may be viewed by appointment at the City Offices.

Many thanks,

Licensing Officer

Winchester City Council

From: Licensing <licensing@winchester.gov.uk> **Sent:** 12 February 2025 4:47 PM

To: (Cllr)

Subject: RE: Application for New Premises Licence - Mi Bello Lugar, Brooklands Farm, Botley Road, Bishops Waltham, Southampton, Hampshire SO32 1DR

Good afternoon

Thank you for your email. Please accept my apologies for the delay in responding.

Attached to this email is a redacted version of the application for you to view, along with the submitted plan.

We have sought further clarity on the application from the applicant, and they have stated the following –

“Although we do envisage people sitting at the premises and drinking their purchases generally this is likely to be only very low numbers of walkers as they pass by, we think that it is highly likely that the greatest proportion of sales will be made to people who take away their purchases to drink at home. Also as discussed having a premises licence will enable us to sell craft cider that we produce at the land online.

Part of our idea also involves occasional small ticketed events at the land, we do not see there being anymore people attending these events than there would be at a small public house. An example of this is that after being made craft ciders are traditionally released in May and small producers have events on their land when they are released.

The whole concept is very much like ‘Cellar Door’ sales in Australia and New Zealand

Just to reiterate, as stated in the application there will be no vehicle access to the premises for general public.”

If you would like any further assistance, please do not hesitate to contact us.

Many thanks,







Licensing Officer

Winchester City Council

Colebrook Street

Winchester, SO23 9LJ

Legend

	Boundary of licensed area
	Site Boundary
	Fire Action Notice
	FAN
	Fire Exit Signage
	Emergency Light Unit
	Multipurpose Extinguisher
	Portable Toilet

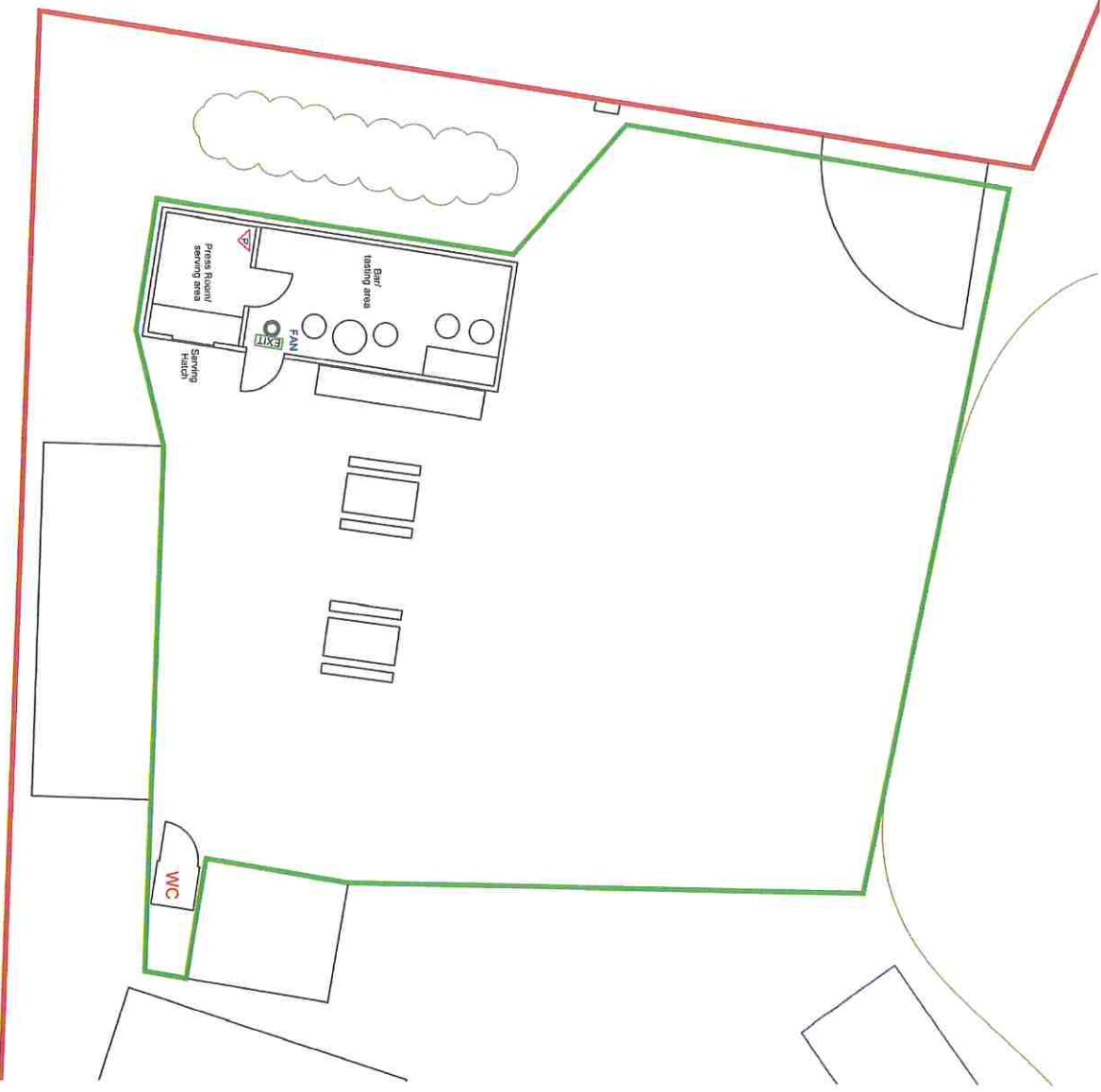

Drawing Title:

Premises licence (Map Reference 50°56'55.4"N 1°13'35.5"W)

Location:

Mi Bello Lugar, Brooklands Farm, Bishops Waltham, SO321DR

Drawn by:

Shane Oliver

Date:

03/02/2025

Scale:

1/100 @ A3



Map Reference 50°56'55.4"N 1°13'35.5"W





Bishop's Waltham Parish Council

Planning and Highways Committee

25.2.25

Agenda Item 15 – Waste Bins – Request for Additional Sites in Bishop's Waltham

- for consideration

Additional waste bins have been requested by the Public at:-

1. Colville Drive footpath

A larger dog waste bin or large dual waste bin.

2. Ashton Corner

A dog waste or dual waste bin on the side of the road that currently doesn't have such.

A further follow up has been requested by the BW Museum Trust regarding their request:

3. Station Road

Dual waste bin outside the Palace Grounds to be installed by WCC.

Proposal:

To consider the additional bin locations as tabled and decide:-

- 1. Whether to change the bin at Colville Drive (which is BWPC owned and maintained) or not.**
- 2. Whether to request WCC install a bin on Ashton Corner or not, or BWPC to consider**
- 3. To pursue WCC regarding the installation of the bin on Station Road or not**

Executive Officer 20.2.25



Bishop's Waltham Parish Council

Planning and Highways Committee

25.2.25

Agenda Item 16 – South Downs National Park – Local Plan Review Response
- for consideration

See page following.

Proposal:

To consider the South Downs National Park – Local Plan Review Response as page following and make recommendations/comments as a result.

Executive Officer 20.2.25

Bishop's Waltham Parish Council Response to the SDNP Local Plan Review - March 2025

Well over half (exact % to be added) of Bishop's Waltham Parish lies in the South Downs National Park. It is interesting to note that only 20% of our parish was considered to be an Area of Outstanding Beauty before the SDNP was created.

We support the majority of your core policies but feel we are impacted by the core policy relating to Homes.

At present we are unable to develop to the north of our village centre as the boundary of the National Park directly abuts the northern housing areas. Consequently all recent housing developments are located to the south of the centre. This has made our aim of encouraging sustainable travel in Bishop's Waltham with a 15 minute walk to the village centre very difficult to achieve. If a higher demand for housing occurs in the future, Bishop's Waltham has very little opportunity to develop with good access to the village centre. Therefore we are looking for potential sites on the border of the National Park. It is our belief that Bishop's Waltham requires smaller affordable homes for our young people who currently cannot afford to live in their home village.

Responses to Policies

SD26. Supply of Homes. Strongly Agree

We agree that 250 new homes should include windfall sites. Any additional housing should meet local needs which are for smaller affordable housing.

SD27. Mix of Homes

We agree with the minor changes to this policy and would strongly support 1/2/3 bedroom houses on the border of the SDNP to the north of the village and that some of those houses should be accessible or adaptable. (NEW 1. Accessible Homes)

SD28. Affordable Homes

We strongly agree with this policy. We would like the condition [s on affordable homes and First Homes to be in perpetuity. We also agree the affordable homes should be integrated into developments. Any loss of affordable housing must be mitigated by additional affordable homes being provided.

SD29 Rural Exception Sites

We agree with this policy. These sites should only be allowed in exceptional circumstances and be 100% affordable housing in perpetuity.

SD 30. Replacement Buildings

SD31 Extensions to existing buildings

We agree that the need in the Bishop's Waltham area is for 1-3 bedroom dwellings. The increase in floor space by 30 metres squared is acceptable. We would like the policy to be clear that annexes must remain ancillary to the main building.

SD32. New Rural Workers Dwellings

We strongly agree with this policy. We want to stipulate that dwellings for rural workers remain with that function except in extreme circumstances. We have a number of examples of tourist dwellings being used as permanent dwellings in our locality such as

SDNP/23/00076/UNCM

SDNP/24/00444/UNCM

BOTH ON THE CURRENT ENFORCEMENT LIST.

In conclusion, we would like to investigate the possibility of some housing on the northern boundary of the SDNP in the future.



Bishop's Waltham Parish Council

Planning and Highways Committee

25.2.25

Agenda Item 17 – Winchester City Council Projects - for consideration

1. Public Toilets – Update

Publicity Notice:-

On Tuesday 18th February, Cllr Conduct and Cllr Marsh met with a WCC Representative to agree the City Council's refurbishment for the Public Toilet Facilities at Basingwell Street car park. The whole Social Club building will be repainted and repairs undertaken to freshen up this central town feature. The toilets will be completely refurbished and brought up to date. We will be adding a baby change unit to provide this frequently requested service. On completion of this upgrade, the Parish Council will be taking on the cleaning of this facility and we hope that we can keep this facility clean and fully functioning, with the community's positive support. *We will keep you up to date regarding a start time for these works, which are anticipated to take approximately six weeks to complete.*

Proposal: To note these updates and consider budgeting for the management of this facility once transferred to the Parish Council

2. Car Park Bin Store – Update from WCC and Proposal from Cllr Homer

The WCC representative has confirmed that oak panelling has been budgeted for the unit once the facility is in use. Letters are due to be sent to business owners regarding the use of the facility once the new waste regulations come into effect this Spring.

Cllr Homer has provided an alternative proposal as attached for consideration.

Proposal:

To consider the update, with new proposal tabled, and make recommendations as a result.

Executive Officer 20.2.25

Main Car Park – Bin Store Alternative Proposal

Prepared By : Cllr Mike Homer Dated 16/02/2025

Current Position;

- 1) The existing bin store bay measures approximately 14m x 3m for the use of businesses along Houchin Street.
- 2) Confirmation of business numbers to be established, as the bin store usage only impacts those that currently store bins on the public highway.
- 3) The current bin store area appears to be oversized for the requirement and has removed 1 No. parking bay that was assigned for disabled usage.
- 4) Bishops Waltham PC and WCC are unable to move forward to a resolution until the bin store is in regular use, and this includes completion of any remedial environmental improvements i.e. timber screening etc.

Proposal Details

- 5) The current bin store be reduced in length by approx. 4m to 10m in length.
- 6) The reduction in length releases an approximate area of 12m² (4x3m). This area could be reallocated for use as motorcycle parking, adjacent to the social club (the use of the area in the NE corner is limited)
- 7) The area currently utilised by motorcycle parking be returned to a car parking space.
- 8) With the addition of a car parking space, a further disabled bay could be added adjacent to the social club in the North end of the carpark. This would increase, or correct the percentage allocation.



Figure 1 – Motorcycle Area



Figure 2 – Reduction in Bin Store Length



Figure 3 – Re-allocated main parking



Bishop's Waltham Parish Council

Planning and Highways Committee

25.2.25

Agenda Item 18 – Correspondence - *for consideration*

- i) Hampshire Water Transfer and Water Recycling Project - Consultation
- ii) Botley Bypass Roundabout - Update
- iii) M27 Junction 10 Improvement Scheme - Update
- iv) St George's Square BT Red Telephone Kiosk Removal - Consultation

Proposal:

To consider the correspondence as tabled and make recommendations as a result.

Executive Officer 20.2.25



Bishop's Waltham Parish Council

Planning and Highways Committee

25.2.25

Agenda Item 18i - Hampshire Water Transfer and Water Recycling Project

- for consideration

A further consultation (?) for the 'Hampshire Water Transfer and Water Recycling Project', part of the 'Water for Life – Hampshire' programme for Southern Water is being held. We have been asked to publicise events for this in our area.

For background, please see the website [Home - Hampshire Water Transfer and Water Recycling Project](#)

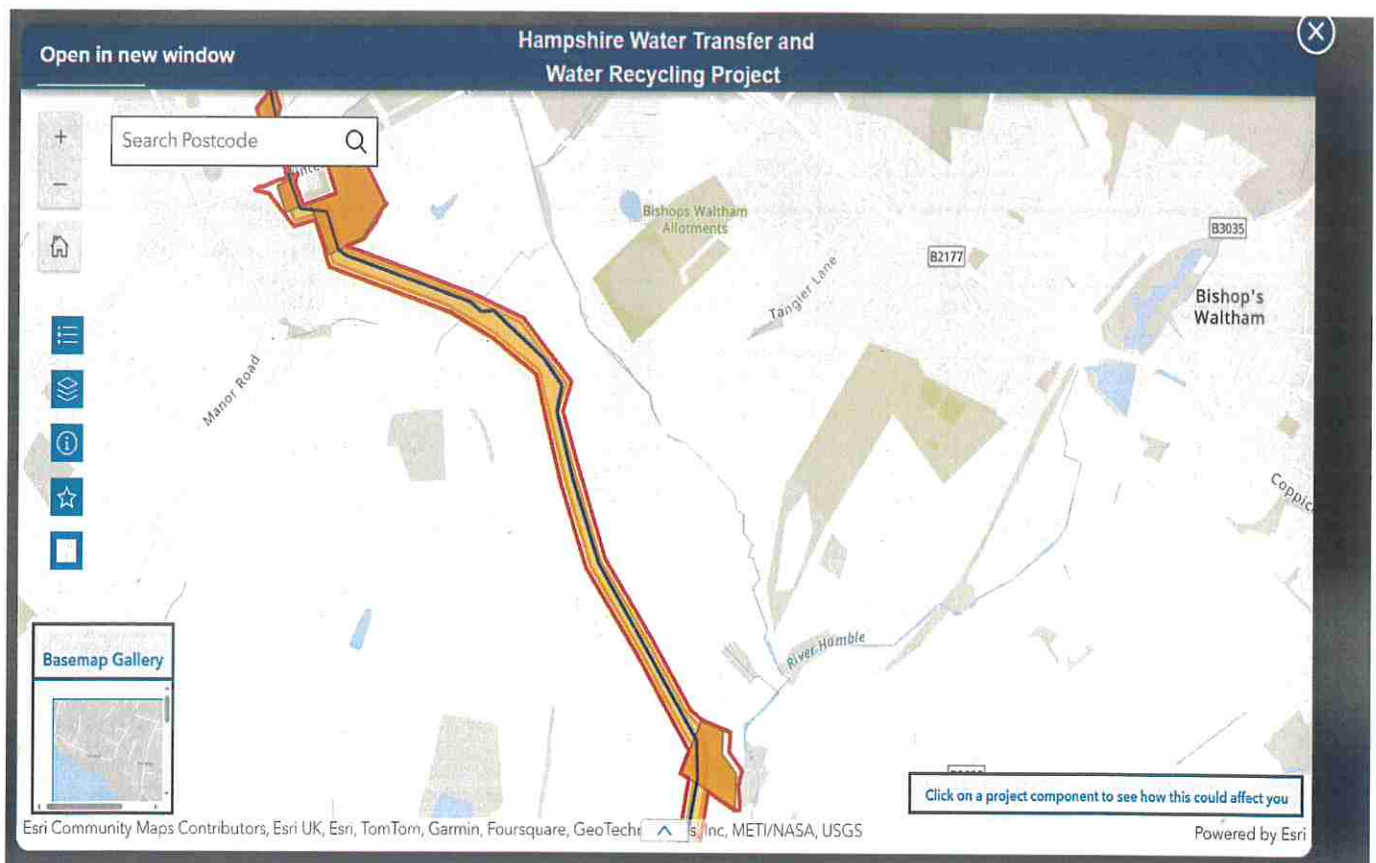

Proposal:

To consider the consultation outlined above and make recommendations as a result.

Executive Officer 20.2.25



Bishop's Waltham Parish Council

Planning and Highways Committee

25.2.25

Agenda Item 18ii– Botley Bypass Roundabout Update - *for consideration*

Hampshire County Council e-newsletter 30.1.25

'Green light' for Botley Bypass completion

We've approved the final phase of the [Botley Bypass](#), a £48 million scheme to be completed by late summer 2027 and designed to reduce congestion in Botley village and support new development. Site clearance will start as soon as February this year, with the main works starting in May. The project includes the creation of a new road eastwards from Winchester Street, a new bridge crossing the River Hamble and a new roundabout at the A334/A3051 junction, along with improved walk and cycle routes for local active travel.

Proposal:

To note the highways matter above and make recommendations as a result.

Executive Officer 20.2.25



Bishop's Waltham Parish Council

Planning and Highways Committee

25.2.25

Agenda Item 18iii – M27 Junction 10 Improvement Scheme - Update

- for consideration

From: M27_Junction10_Improvement <M27Jct10@hants.gov.uk>

Sent: 05 February 2025 13:30

Subject: Help Us Spread the Word: M27 Junction 10 Improvement Scheme E-Newsletter

We are reaching out to request your assistance in sharing information about the M27 Junction 10 improvement scheme with your parishioners. We have launched an e-newsletter to keep the community informed about the latest developments, traffic management updates, and important information related to the project. Please visit the scheme web page for more information; [M27 Junction 10 improvements | Transport and roads | Hampshire County Council](#)

We would greatly appreciate it if you could share the following message and subscription link through your social media and network channels

Stay Informed: Sign Up for the M27 Junction 10 Improvement Scheme E-Newsletter

Hampshire County Council is delivering the M27 J10 improvements scheme to facilitate the development of Welborne Garden Village. The project includes new and improved links in all directions from the M27 to the A32 and the surrounding local highway network. The County Council is working closely with National Highways and has appointed VolkerFitzpatrick as the main contractor.

Sign up now to receive regular updates on the M27 Junction 10 improvement scheme for scheme progress and traffic management. Click [here](#) to subscribe to our e-newsletter. You can unsubscribe at any time.

Thank you for your co-operation.

Kind Regards

Programme Engagement Team Leader
Capital Delivery, Implementation Team
Universal Services
Hampshire County Council

Proposal:

To consider the update outlined above and make recommendations as a result.

Executive Officer 20.2.25



Bishop's Waltham Parish Council

Planning and Highways Committee

25.2.25

Agenda Item 18iv – St George's Square BT Red Telephone Kiosk Removal - Consultation - for consideration

A notice proposing the removal of the telephony and kiosk has been found in the unit dated 25.1.25.

Any comments are to be directed to WCC Planning Department within 42 days about this proposal.

The Planning Department will then confer with BT about this matter.

The BT engineer who spoke to the resident concerned noted that the last calls made from the kiosk were 999 calls so evidence that this facility is still required.

The Parish Council has previously offered to adopt the kiosk but at that time it was considered that the unit needed to remain operational as a key contact point if without a mobile phone in town, near pubs or the bus stop.

It was also noted that the kiosk is sited within the curtilage of the property and permission from the landowner would need to be sought.

The tenant of the building confirmed this month that they would support the kiosk remaining at the site as an iconic landmark for the Square.



Proposal: To consider the consultation outlined above and make recommendations for action, or not, as a result.

Executive Officer 20.2.25



Bishop's Waltham Parish Council

Planning and Highways Committee

25.2.25

Agenda Item 19 – Accessibility Project - Update - for information

A meeting was requested by HCC representatives to discuss priorities for the funding spend on the Accessibility Project.

A Teams call was held on 20.2.25 with the HCC representatives, the Executive Officer and Cllr Williams.

The three designs have been confirmed but are over budget.

(Designs circulated to Committee separately as not publicly available as yet).

The Parish Council have been asked to consider if they would agree to continuing with the schemes or a phased approach to such.

1. **Bank Street/High Street/Houchin Street – ready to progress**
2. **Houchin Street – ready to progress**

These are linked works and would be beneficial to undertake at the same time.

3. **Lower Basingwell Street – ready to progress but works greater than originally planned.**

This could be postponed or completed in stages. However, the economies of scale will differ if this is postponed from the other two works.

The desire for the proposed Puffin Crossing was discussed but the anticipated large cost of this needed greater consideration. The representative would provide a summary of costings to make the community aware of the scale of this project.

A further meeting with a HCC representative was planned for 25.2.25 in advance of the evening Council meeting.

.....

Proposal:

- i) **To consider the priorities for the project and agree to which of the three should progress in 2025.**
- ii) **To make recommendations for further phases of the Accessibility Project, if appropriate.**

Executive Officer 20.2.25